

Madison, Wisconsin

CITY OF MADISON

CITY ENGINEERING DIVISION

DEPARTMENT OF PUBLIC WORKS

PLAN OF PROPOSED IMPROVEMENT

INDEX OF SHEETS

SHEET NO.	TITLE
1	
U1-U3	SANITARY PLAN AND PROFILE

PUBLIC IMPROVEMENT PROJECT APPROVED

SEPTEMBER 6, 2016

BY THE COMMON COUNCIL
OF MADISON, WISCONSIN

PUBLIC IMPROVEMENT DESIGN
APPROVED BY:

 2/4/20
City Engineer Date

SANITARY SEWER
DESIGNED BY:

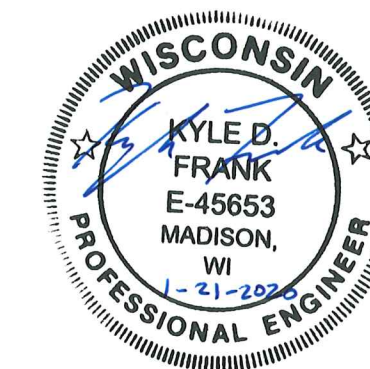





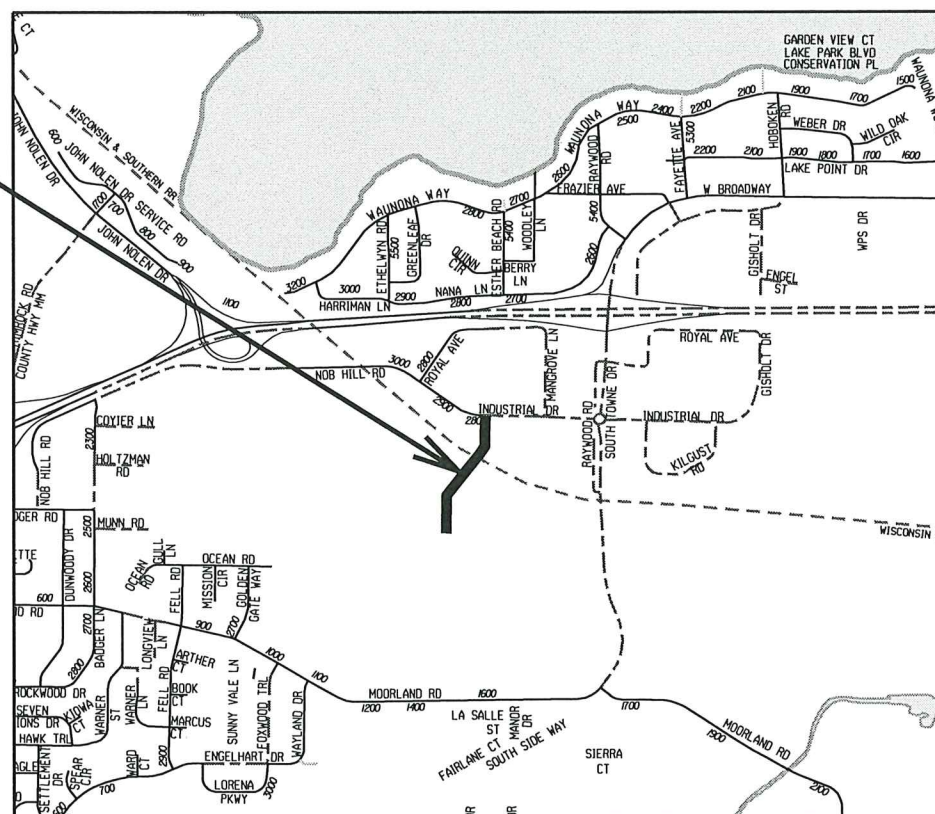
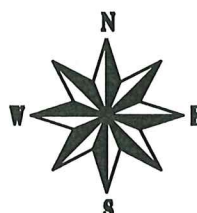

RIMROCK INTERCEPTOR - INDUSTRIAL DRIVE EXTENSION

CITY PROJECT NO. 11446

CONTRACT NO. 8543

PROJECT
LOCATION

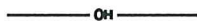

CONVENTIONAL SIGNS	
FIELD VERIFY ALL UTILITY LOCATIONS	
GAS	
STORM SEWER	
SANITARY SEWER	
WATER	
OVERHEAD ELECTRIC	
POWER POLE	

NOTES:
ALL GUTTERS SHALL DRAIN WITH A MINIMUM GRADE OF 0.50% TOWARD STORM SEWER INLETS.

SIDEWALK RAMPS AND CURB THRU SIDEWALK RAMPS SHALL HAVE A MAXIMUM SLOPE OF 1" PER 12". SIDEWALK AND CURB RAMPS SHALL BE CONSTRUCTED WITH A SIDE SLOPE OF 2.00%. SIDEWALK SHALL HAVE A MINIMUM LONGITUDINAL SLOPE OF 0.50% AND A MAXIMUM LONGITUDINAL SLOPE OF 5.00%

PLOT SCALE:

PLOT NAME:

REV. DATE:

ORIGINATOR: CITY OF MADISON, STREETS DIVISION

NOTE: TREE REMOVALS SHOULD BE MINIMIZED AND SHOULD ONLY BE AS NEEDED FOR ACCESS AND CONSTRUCTION. CITY ENGINEERING PROVIDE APPROVAL FOR TREE REMOVALS BEFORE TREES ARE REMOVED

CONTRACTOR SHALL USE SWAMP MATS AS NEEDED TO ACCESS WORK AREAS. SWAMP MATS SHALL BE PAID UNDER MOBILIZATION AND SHALL BE REMOVED AT THE END OF THE PROJECT.

0710-303-0099-2
 MADISON METRO SEWERAGE
 DISTRICT NINE SPRINGS
 1610 MOORLAND ROAD

0710-303-0099-2
 MADISON METRO SEWERAGE
 DISTRICT NINE SPRINGS
 1610 MOORLAND ROAD

0710-303-0099-2
 MADISON METRO SEWERAGE
 DISTRICT NINE SPRINGS
 1610 MOORLAND ROAD

0710-303-0099-2
 MADISON METRO SEWERAGE
 DISTRICT NINE SPRINGS
 1610 MOORLAND ROAD

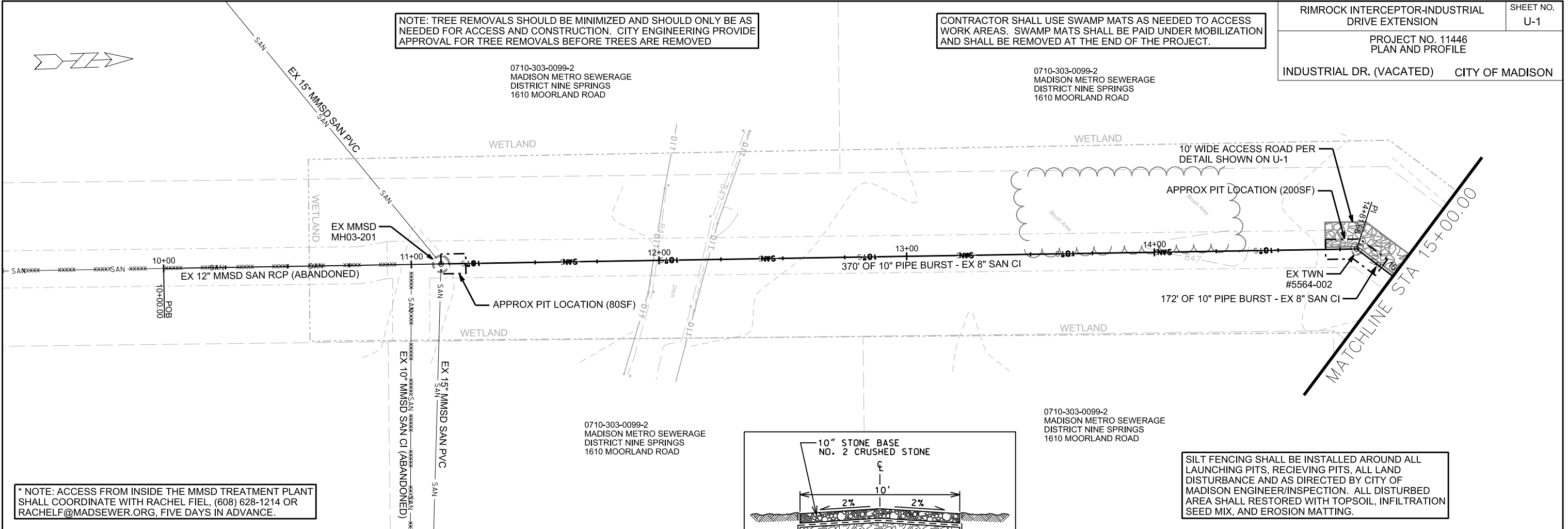
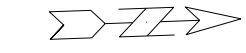

* NOTE: ACCESS FROM INSIDE THE MMSD TREATMENT PLANT SHALL COORDINATE WITH RACHEL FIEL, (608) 628-1214 OR RACHELF@MADSEWER.ORG, FIVE DAYS IN ADVANCE.

* NOTE: CONTRACTOR SHALL CONTACT RAY SCHNEIDER (608) 347-3628 OR RAYS@MADSEWER.ORG, FIVE DAYS PRIOR TO MAKING THE CONNECTION TO MMSD MH03-103 TO ARRANGE FOR INSPECTION OF THE CONNECTION. CONTRACTOR SHALL BE RESPONSIBLE FOR THE PERMIT APPLICATION FEE (\$1,150.00)

SILT FENCING SHALL BE INSTALLED AROUND ALL LAUNCHING PITS, RECEIVING PITS, ALL LAND DISTURBANCE AND AS DIRECTED BY CITY OF MADISON ENGINEER/INSPECTION. ALL DISTURBED AREA SHALL RESTORED WITH TOPSOIL, INFILTRATION SEED MIX, AND EROSION MATTING.

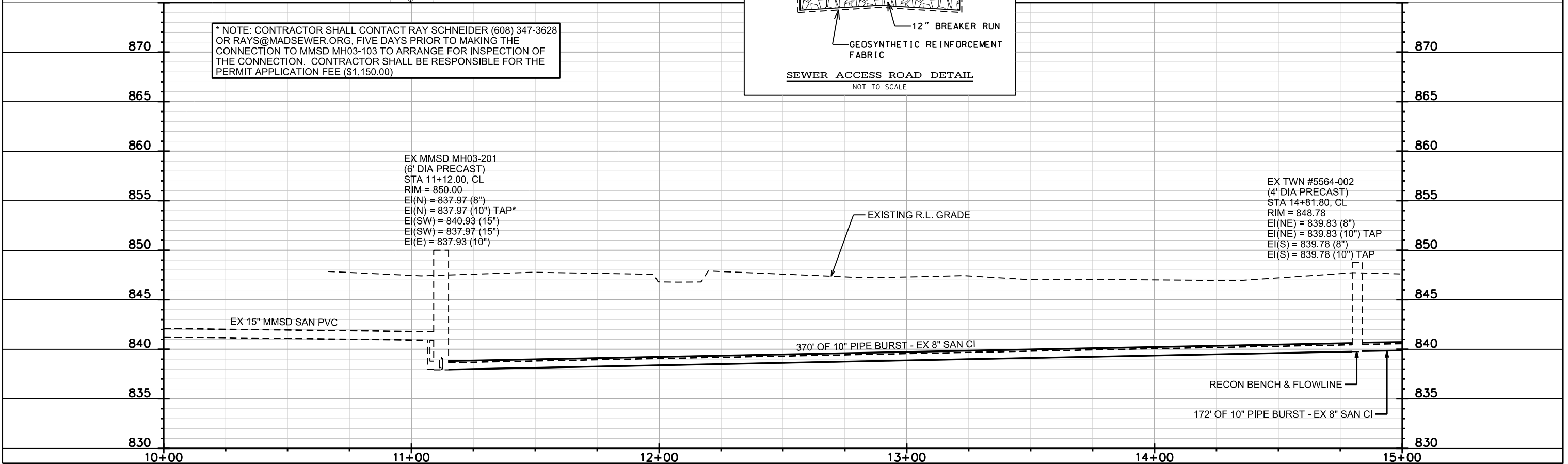
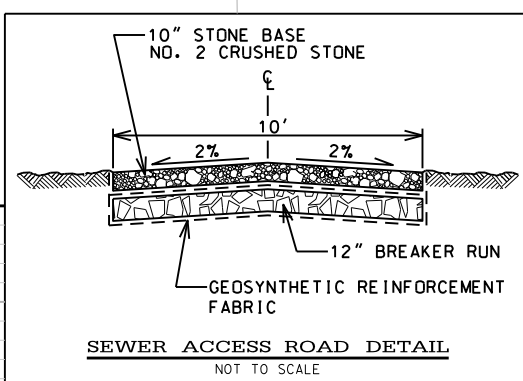

EX MMSD MH03-201
 (6' DIA PRECAST)
 STA 11+12.00, CL
 RIM = 850.00
 EI(N) = 837.97 (8")
 EI(N) = 837.97 (10") TAP*
 EI(SW) = 840.93 (15")
 EI(SW) = 837.97 (15")
 EI(E) = 837.93 (10")

EX TWN #5564-002
 (4' DIA PRECAST)
 STA 14+81.80, CL
 RIM = 848.78
 EI(NE) = 839.83 (8")
 EI(NE) = 839.83 (10") TAP
 EI(S) = 839.78 (8")
 EI(S) = 839.78 (10") TAP

PLOT SCALE:
 PLOT NAME:
 REV. DATE:
 ORIGINATOR: CITY OF MADISON, STREETS DIVISION

CONTRACTOR SHALL USE SWAMP MATS AS NEEDED TO ACCESS WORK AREAS. SWAMP MATS SHALL BE PAID UNDER MOBILIZATION AND SHALL BE REMOVED AT THE END OF THE PROJECT.

0710-303-0099-2
 MADISON METRO SEWERAGE DISTRICT NINE SPRINGS
 1610 MOORLAND ROAD

WETLAND

WETLAND

WETLAND

WETLAND

MATCHLINE STA 15+00.00

MATCHLINE STA 20+00.00

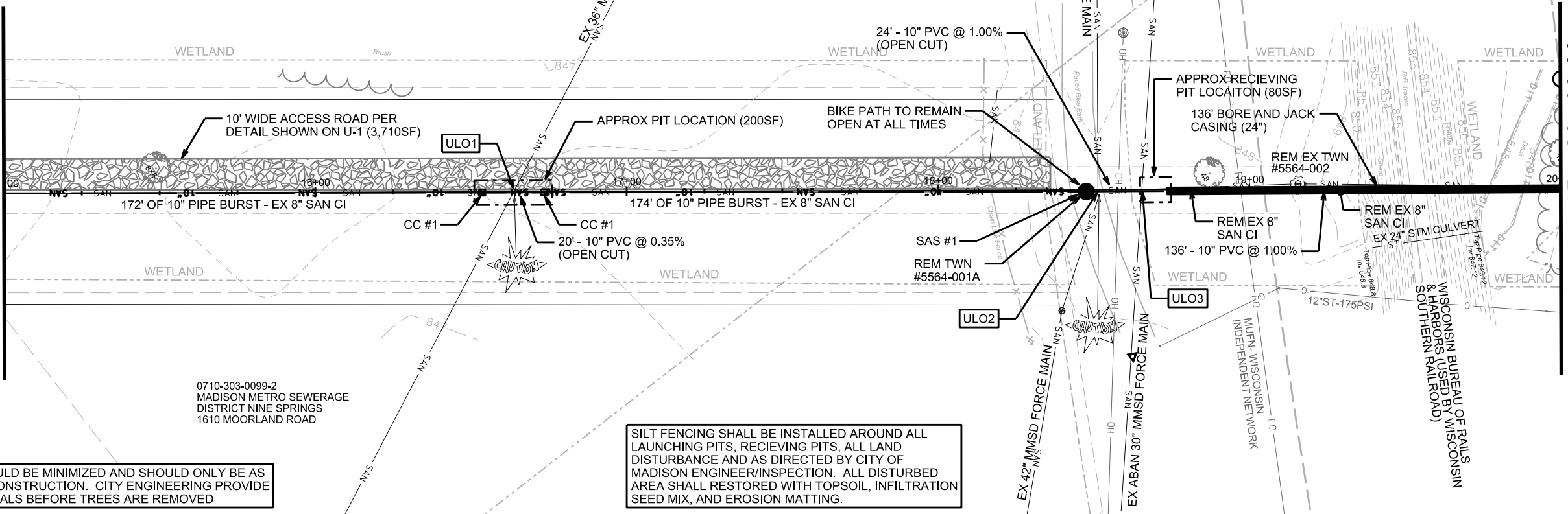

NOTE: TREE REMOVALS SHOULD BE MINIMIZED AND SHOULD ONLY BE AS NEEDED FOR ACCESS AND CONSTRUCTION. CITY ENGINEERING PROVIDE APPROVAL FOR TREE REMOVALS BEFORE TREES ARE REMOVED

SILT FENCING SHALL BE INSTALLED AROUND ALL LAUNCHING PITS, RECEIVING PITS, ALL LAND DISTURBANCE AND AS DIRECTED BY CITY OF MADISON ENGINEER/INSPECTION. ALL DISTURBED AREA SHALL RESTORED WITH TOPSOIL, INFILTRATION SEED MIX, AND EROSION MATTING.

PLOT SCALE:

PLOT NAME:

REV. DATE:

ORIGINATOR: CITY OF MADISON, STREETS DIVISION

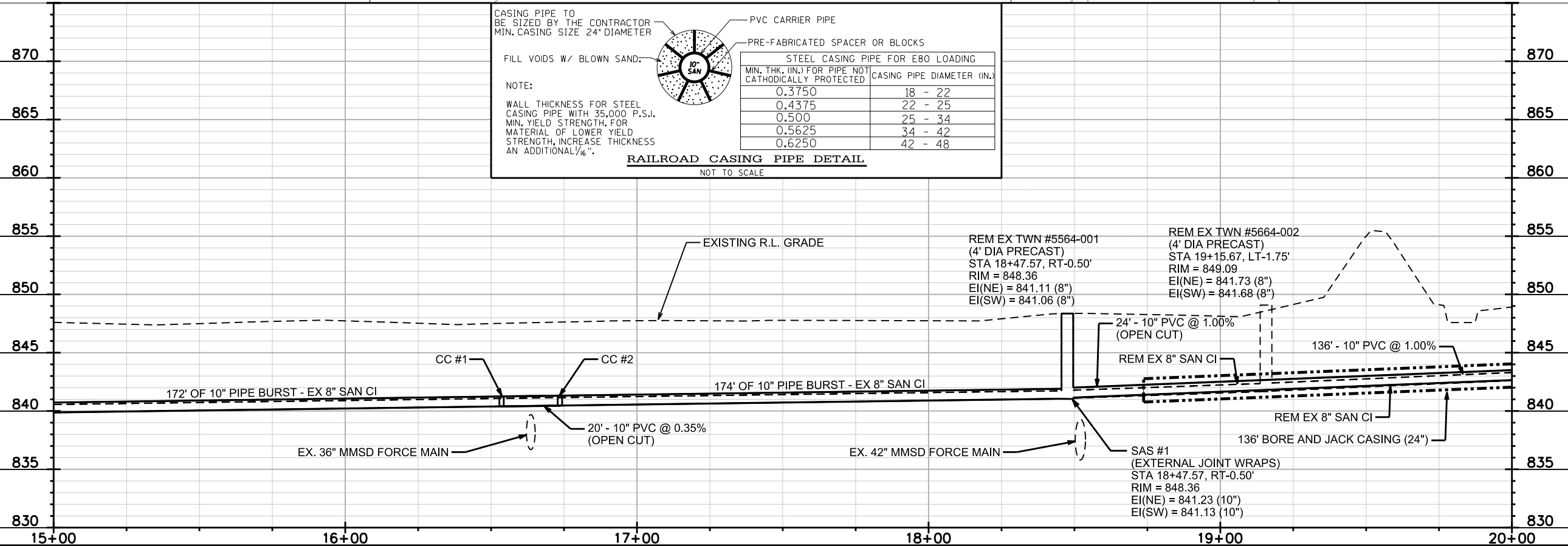

CASING PIPE TO BE SIZED BY THE CONTRACTOR MIN. CASING SIZE 24" DIAMETER

FILL VOIDS W/ BLOWN SAND.

NOTE:
 WALL THICKNESS FOR STEEL CASING PIPE WITH 35,000 P.S.I. MIN. YIELD STRENGTH. FOR MATERIAL OF LOWER YIELD STRENGTH, INCREASE THICKNESS AN ADDITIONAL 1/16".

STEEL CASING PIPE FOR E80 LOADING	
MIN. THK. (IN.) FOR PIPE NOT CATHODICALLY PROTECTED	CASING PIPE DIAMETER (IN.)
0.3750	18 - 22
0.4375	22 - 25
0.5000	25 - 34
0.5625	34 - 42
0.6250	42 - 48

RAILROAD CASING PIPE DETAIL
 NOT TO SCALE

CONTRACTOR SHALL USE SWAMP MATS AS NEEDED TO ACCESS WORK AREAS. SWAMP MATS SHALL BE PAID UNDER MOBILIZATION AND SHALL BE REMOVED AT THE END OF THE PROJECT.

SILT FENCING SHALL BE INSTALLED AROUND ALL LAUNCHING PITS, RECEIVING PITS, ALL LAND DISTURBANCE AND AS DIRECTED BY CITY OF MADISON ENGINEER/INSPECTION. ALL DISTURBED AREA SHALL RESTORED WITH TOPSOIL, INFILTRATION SEED MIX, AND EROSION MATTING.

0710-302-1502-6
 UEC PROPERTIES LLC
 2855 INDUSTRIAL DRIVE

0710-302-1501-8
 RUNDLE-SPENCE MFG CO,
 C/O DAVID E SPENCE
 2815 INDUSTRIAL DRIVE

0710-302-1501-8
 RUNDLE-SPENCE MFG CO,
 C/O DAVID E SPENCE
 2815 INDUSTRIAL DRIVE

0710-302-0093-6
 RUNDLE-SPENCE MFG CO
 C/O DAVID E. SPENCE
 2811 INDUSTRIAL DRIVE

NOTE: TREE REMOVALS SHOULD BE MINIMIZED AND SHOULD ONLY BE AS NEEDED FOR ACCESS AND CONSTRUCTION. CITY ENGINEERING PROVIDE APPROVAL FOR TREE REMOVALS BEFORE TREES ARE REMOVED

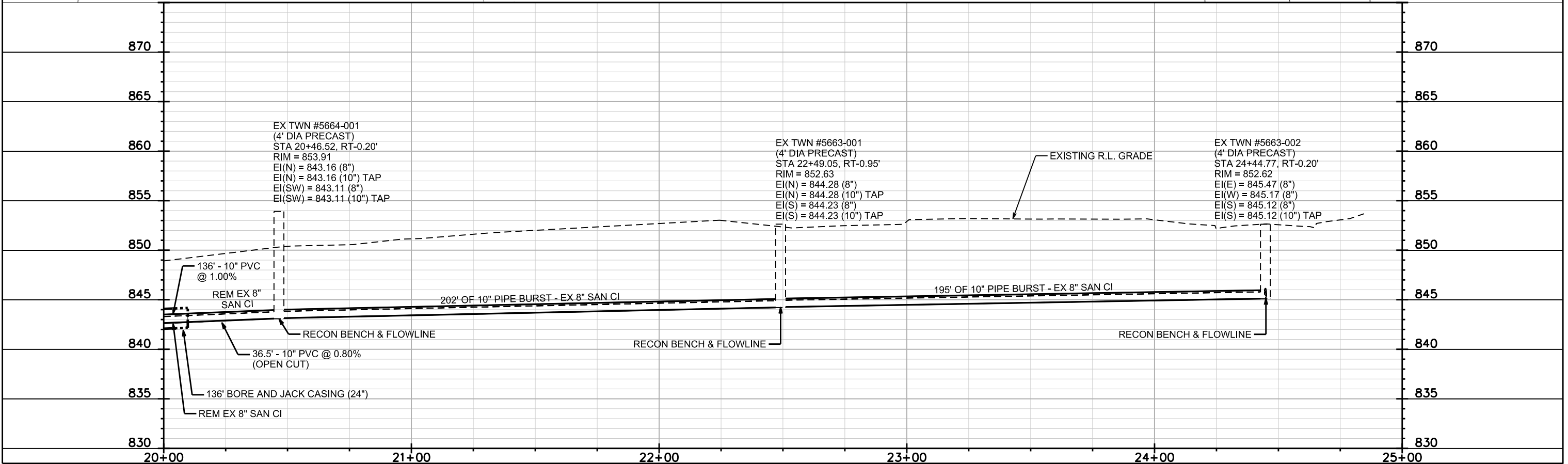
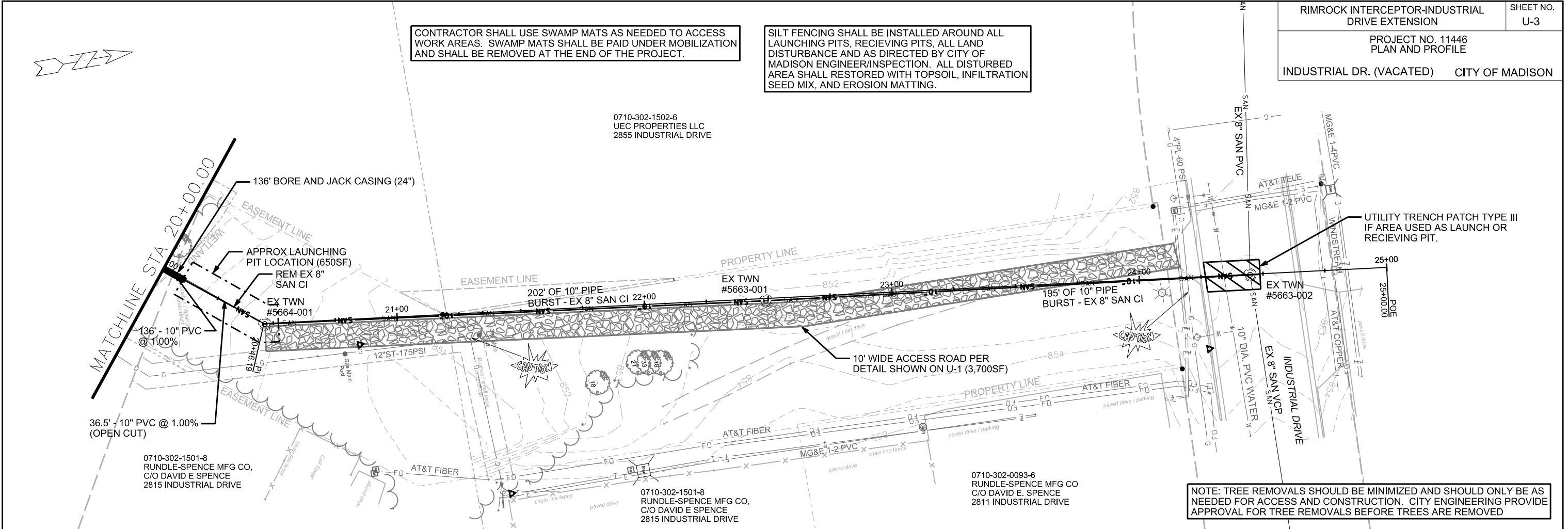

PLOT SCALE:
 PLOT NAME:
 REV. DATE:
 ORIGINATOR: CITY OF MADISON, STREETS DIVISION